



- |                |                 |
|----------------|-----------------|
| ALLIS-CHALMERS | NYK-NICHIYU     |
| BAKER          | O & K           |
| BALKANCAR      | PEG             |
| BOLZONI        | PETTIBONE       |
| BRUNILIFT      | PRAT            |
| BT             | RANSOMES        |
| CASCADE        | RAYMOND         |
| CATERPILLAR    | SALEV           |
| CLARK          | SAMSUNG         |
| COVENTRY       | SAXBY           |
| CROWN          | SCHRECK         |
| DESTA          | SHINKO          |
| ELECAR         | STEINBOCK       |
| EML            | STILL           |
| FANTUZZI       | TCM             |
| FENWICK        | TOYOTA          |
| FIAT-OM        | UNITRAC         |
| HALLA-HYUNDAI  | WAGNER          |
| HENLEY         | YALE            |
| HYSTER         | BCA             |
| JELAU          | BOWER           |
| JUNGHEINRICH-  | DÜRKOPP         |
| AMEISE         | FAG             |
| KALMAR         | HIC             |
| KAUP           | INA             |
| KOMATSU        | KOYO            |
| LANCER BOSS    | MC GILL         |
| LANSING        | NACHI           |
| LINDE          | NEW DEP BEARING |
| LUGLI          | NSK-HOOVER      |
| MANDIGERS      | NTN             |
| MANITOU        | RBC             |
| MIC            | RHP BEARINGS    |
| MITSUBISHI     | SFK             |
| MORA           | TIMKEN          |
| MTT            | TORRINGTON      |
| NISSAN         |                 |

MAST & CHAIN ROLLERS

TECHNICAL DETAIL: MAST ROLLERS AND CHAIN ROLLERS

EXAMPLE MAST ROLLER

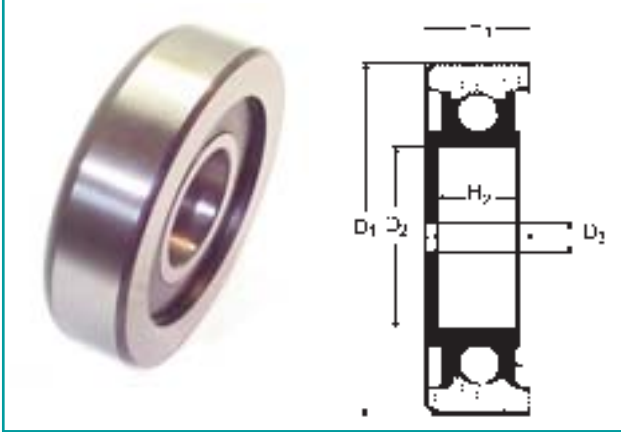

EXAMPLE CHAIN ROLLER

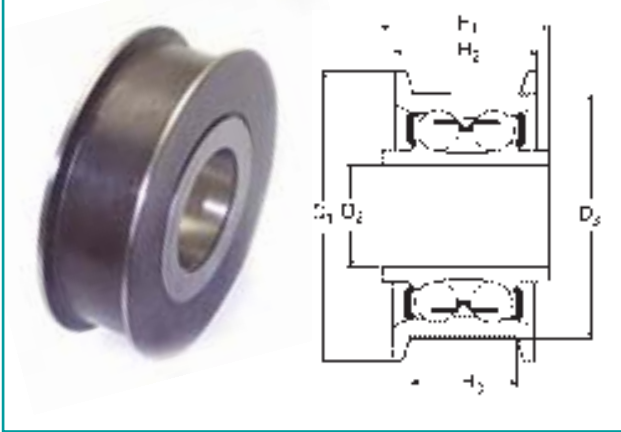

Company: .....

Customer code: .....

Name: .....

Fax number: .....

Truck make: .....

Truck type: ..... Serial nr.: .....

- 1 TY ..... type (check on following pages)
- 2 D1 ..... max. diameter (mm)
- 3 D2 ..... diameter, as per picture (mm)
- 4 D3 ..... diameter, as per picture (mm)
- 5 D4 ..... diameter, as per picture (mm)
- 6 D5 ..... diameter, as per picture (mm)
- 7 C ..... distance, as per picture (mm)
- 8 H1 ..... max. distance (mm)
- 9 H2 ..... distance, as per picture (mm)
- 10 H3 ..... distance, as per picture (mm)
- 11 H4 ..... distance, as per picture (mm)



**TYPE 01A**



**TYPE 02A**

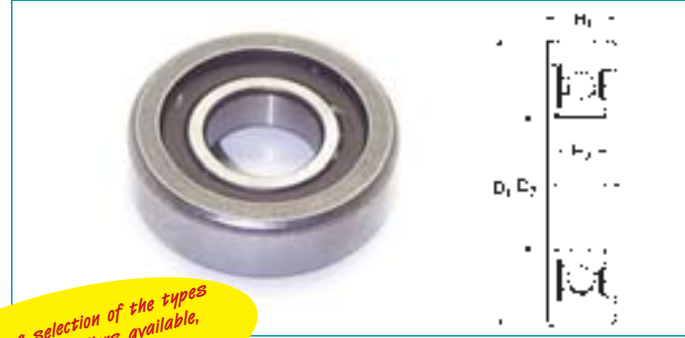

*This is only a selection of the types of mast & chain rollers available, please contact us for further information.*

**TYPE 03A**

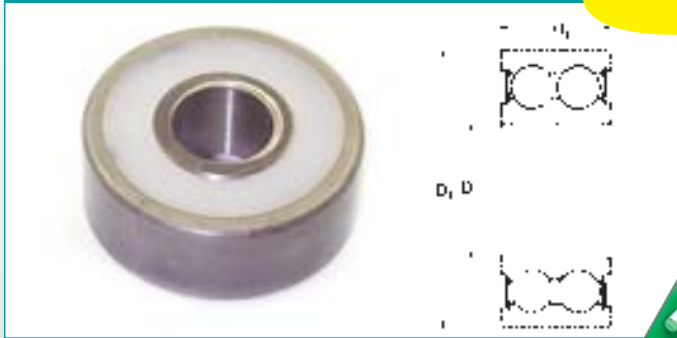

**TYPE 04A**

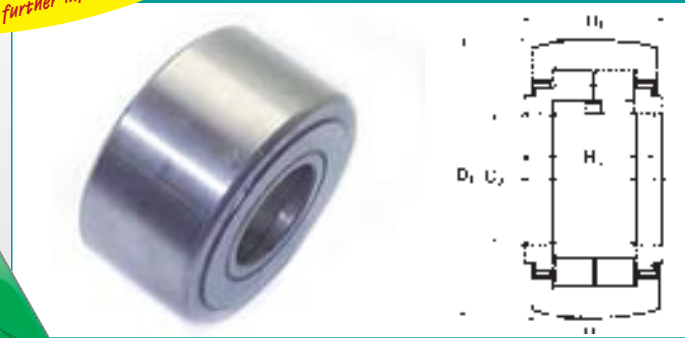

**TYPE 05A**



**TYPE 06A**



**TYPE 07A**



**TYPE 08A**



**TYPE 09A**



**TYPE 10A**



TYPE 11A



TYPE 12A

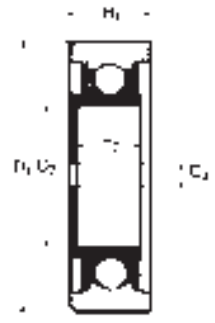

TYPE 13A



TYPE 14A

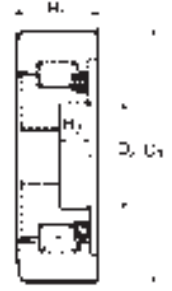

*This is only a selection of the types of mast & chain rollers available, please contact us for further information.*

TYPE 15A

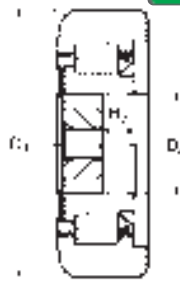

USE REF. 107TA9655  
HAMMER-MOUNTED

TYPE 16A

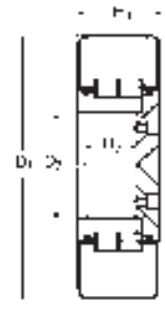

TYPE 17A



TYPE 18A



TYPE 19A

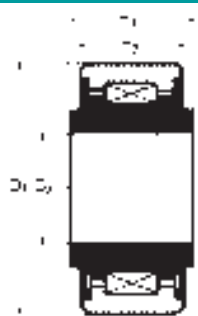

TYPE 20A

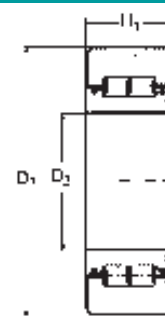



TYPE 21A

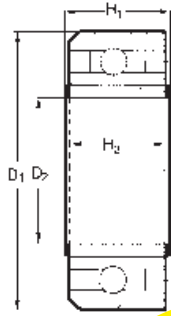

TYPE 22A

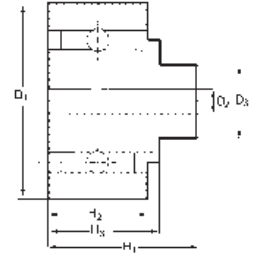

*This is only a selection of the types of mast & chain rollers available, please contact us for further information.*

TYPE 23A



TYPE 24A

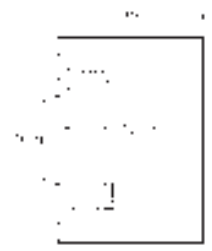

TYPE 25A

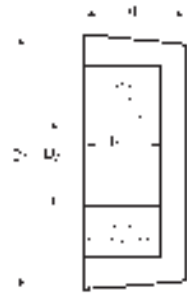

TYPE 26A

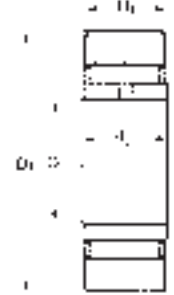

TYPE 01B

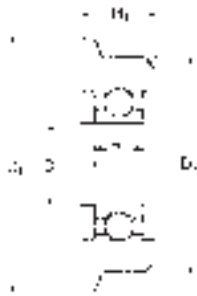

TYPE 02B

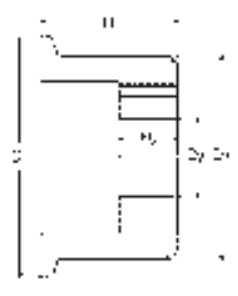

TYPE 01C



TYPE 02C

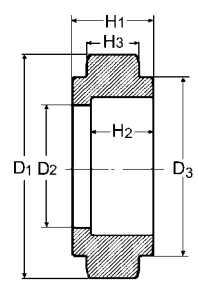

**TYPE 01D**

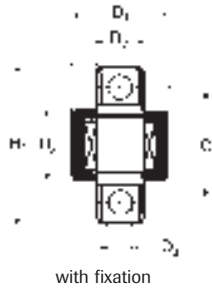

**TYPE 02D**



**TYPE 03D**



**TYPE 04D**

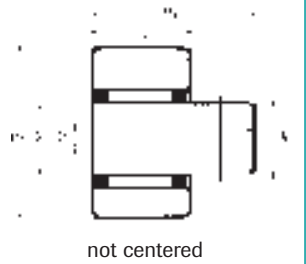

*This is only a selection of the types of mast & chain rollers available, please contact us for further information.*

USE REF. 107TA9655  
HAMMER-MOUNTED

**TYPE 05D**

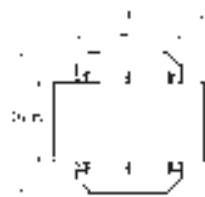

**TYPE 06D**



**TYPE 07D**

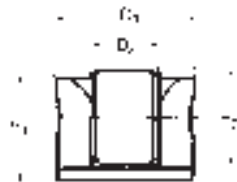

**TYPE 08D**

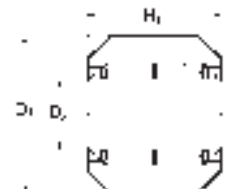

**TYPE 09D**



**TYPE 10D**

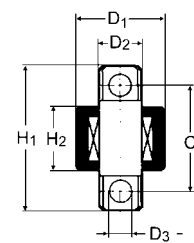



TYPE 11D

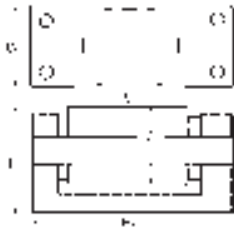

TYPE 12D



*This is only a selection of the types of mast & chain rollers available, please contact us for further information.*

TYPE 13D

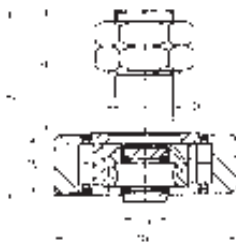

TYPE 14D

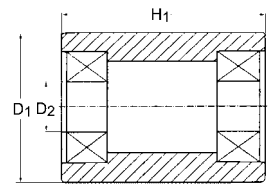

TYPE 15D

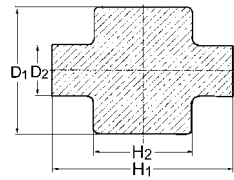

TYPE 16D

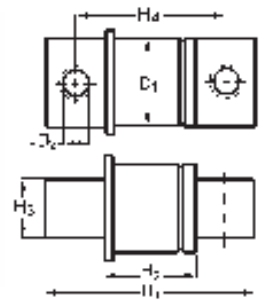

TYPE 17D

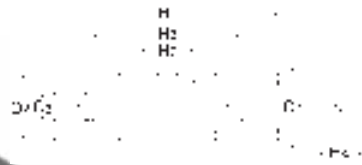

TYPE 01E



TYPE 02E

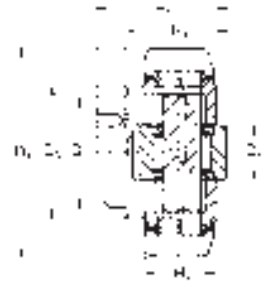

TYPE 03E

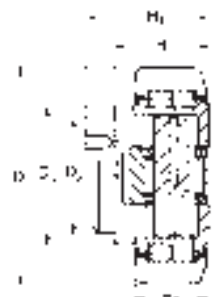

**TYPE 04E**

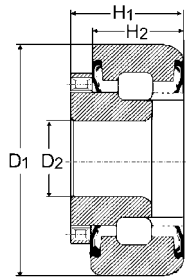
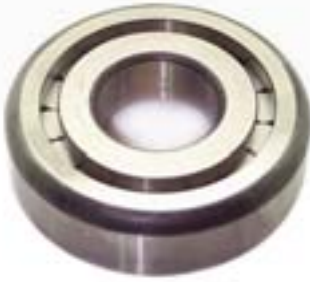

**TYPE 05E**



**TYPE 06E**

all types of roller shafts can be supplied on request with the help of drawing and dimensions. Please contact us.

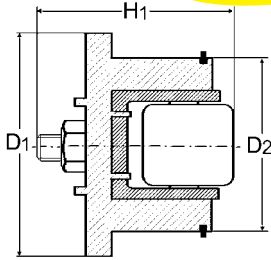

**TYPE 07E**

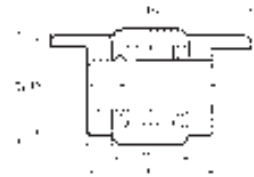

**TYPE 08E**



USE REF. 107TA9655  
HAMMER-MOUNTED

**TYPE 09E**

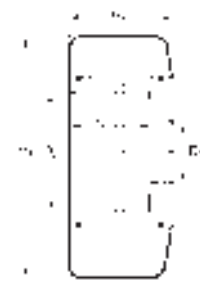

**TYPE 10E**

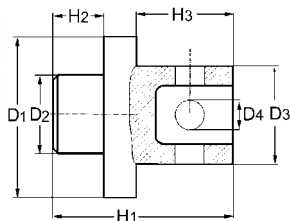

**TYPE 01F**



**TYPE 02F**

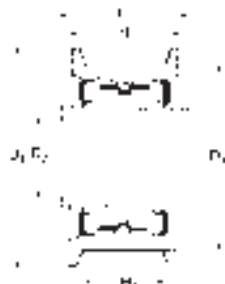

**TYPE 03F**



*This is only a selection of the types of mast & chain rollers available, please contact us for further information.*





TYPE 04F

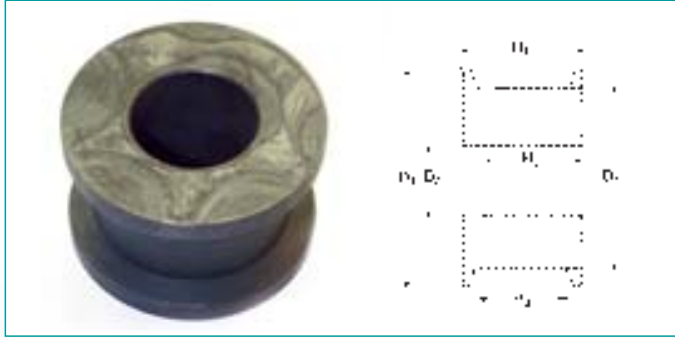

TYPE 05F

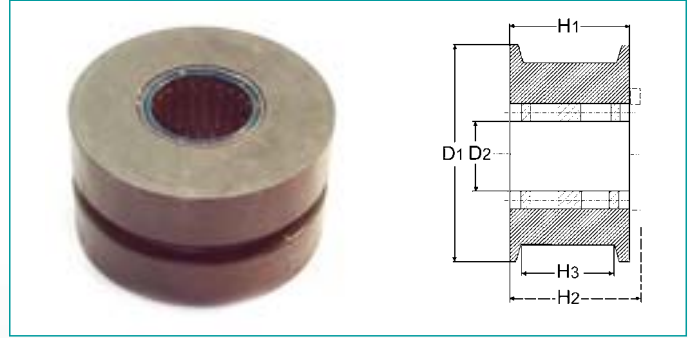

TYPE 06F

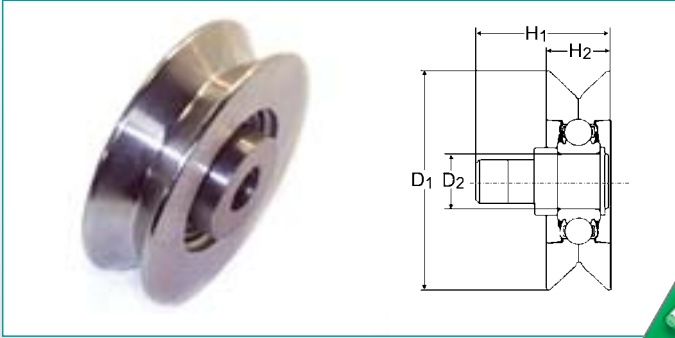

TYPE 07F



TYPE 08F

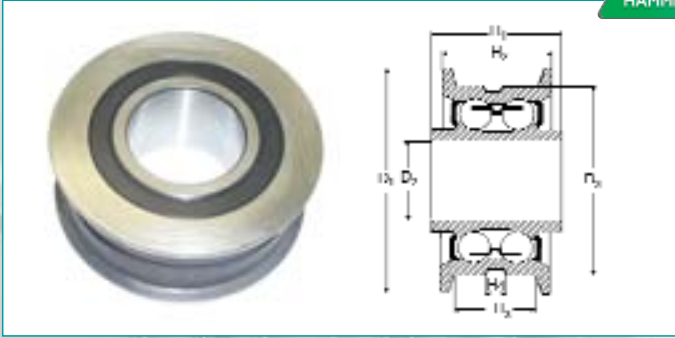

MAST ROLLERS AND NOTES

*This is only a selection of the types of mast & chain rollers available, please contact us for further information.*



NOTES

# NOTES

Lined writing area consisting of multiple horizontal blue lines for notes.