

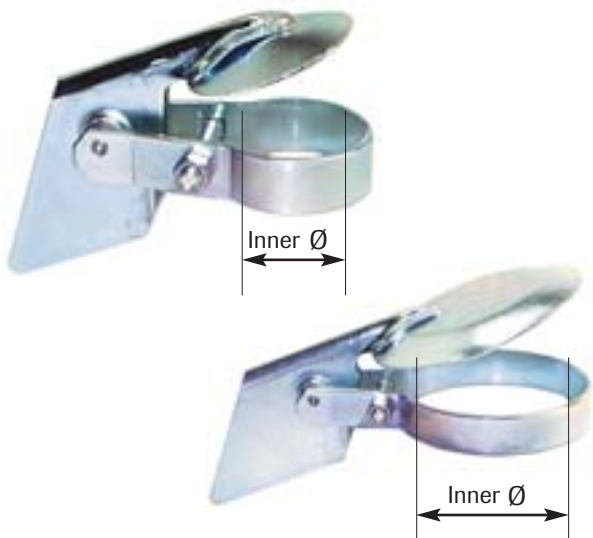

EXHAUST & ACCESSORIES

## EXHAUST CAPS FOR FORKLIFT TRUCKS



Inner diameter		REF
(inch)	Ø (mm)	
2"	51	107TA1881
2" 1/4	57	107TA1882
2" 1/2	63	107TA1883
2" 3/4	70	107TA1884
3"	76	107TA1885
3" 1/2	89	107TA1886
4"	102	107TA1887



## FLEXIBLE EXHAUST PIPES

Inner Diameter	REF galvanised	REF stainless steel
38 mm	107TA1862	-
40 mm	107TA1864	107TA1863
42 mm	107TA1865	-
45 mm	107TA1867	107TA1866
48 mm	107TA1868	-
50 mm	107TA1872	107TA1869
55 mm	107TA1873	107TA1870
60 mm	107TA1874	107TA1871
65 mm	107TA1875	-
70 mm	107TA1878	107TA1876
75 mm	107TA1879	107TA1877
80 mm	107TA1880	-

## HACKSAWS AND SET OF BLADES



**SET OF 2**  
REF 107TA7558  
20 TND + 14 TND



REF 107TA7555  
18 T - 100pcs.

REF 107TA7556  
24 T - 100pcs.

REF 107TA7557  
32 T - 100pcs.



**STANDARD EXHAUST CLAMPS**

**EXHAUST CLAMPS**

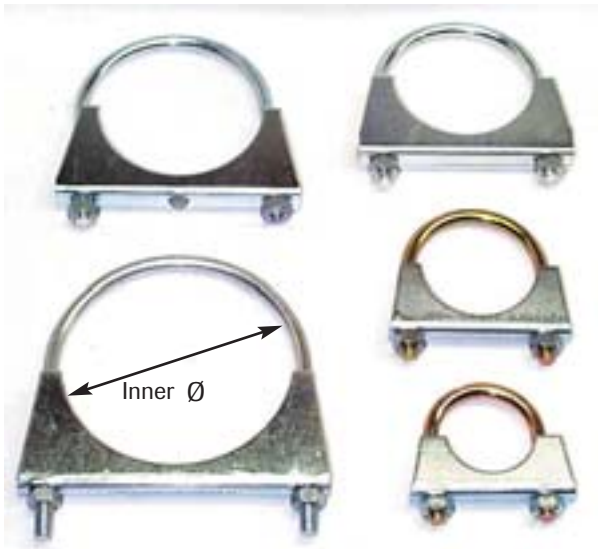

Inner diameter (mm) (inch)		Tube outer diameter (mm) (inch)		REF
35	1" 3/8	32	1" 1/4	107TA1895
38	1" 1/2	35	1" 3/8	107TA1896
41	1" 5/8	38	1" 1/2	107TA1897
44	1" 3/4	41	1" 5/8	107TA1898
48	1" 7/8	44	1" 3/4	107TA1899
51	2"	48	1" 7/8	107TA1900
54	2" 1/8	51	2"	107TA1901
58	2" 1/4	54	2" 1/8	107TA1902
60	2" 3/8	57	2" 1/4	107TA1903
67	2" 5/8	63	2" 1/2	107TA1904
73	2" 7/8	67	2" 3/4	107TA1905
79	3" 1/8	76	3"	107TA1906
105	4" 1/8	102	4"	107TA1907

**HEAVY DUTY EXHAUST CLAMPS**

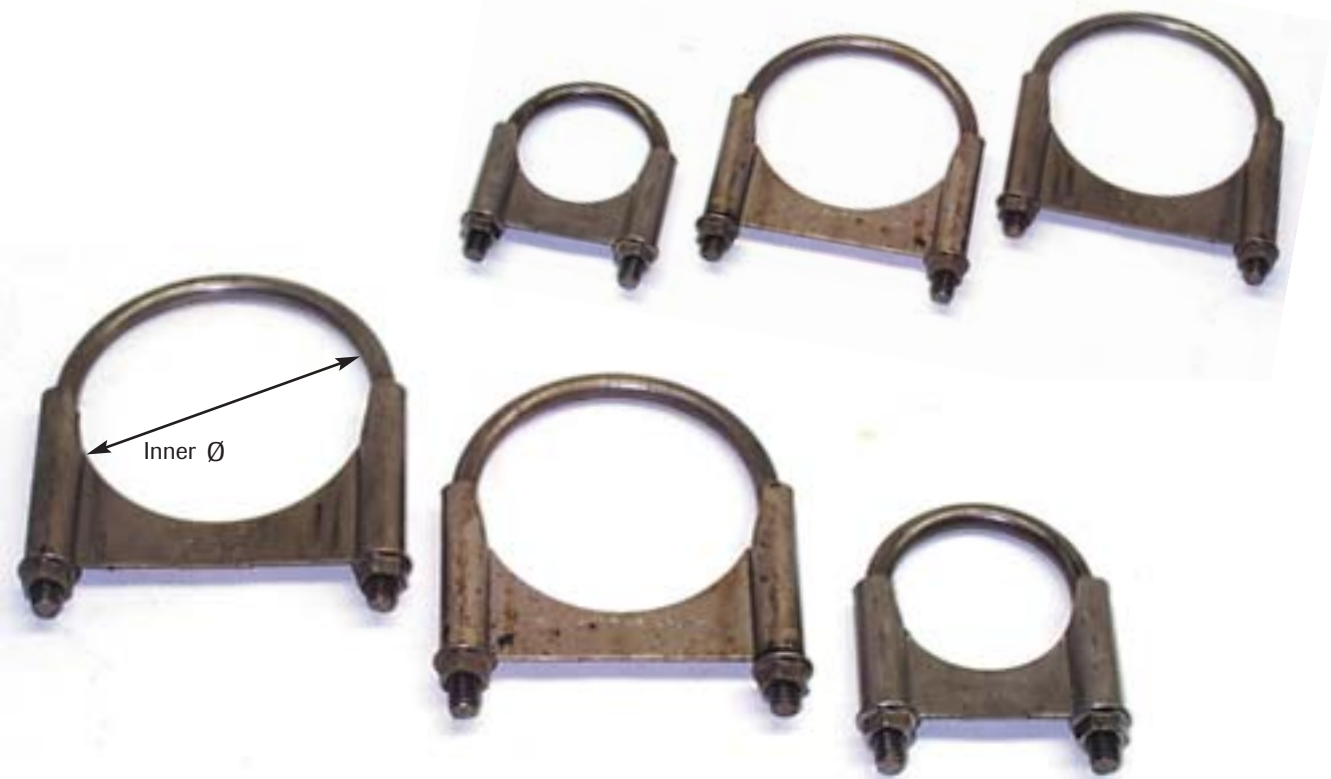

**Inner diameter  
(mm) (inch)**

**REF**

54 2" 1/8  
67 2" 5/8  
73 2" 7/8  
79 3" 1/8  
86 3" 3/8  
92 3" 5/8  
113 4" 7/16

107TA1888  
107TA1889  
107TA1890  
107TA1891  
107TA1892  
107TA1893  
107TA1894



### CATALYTIC CONVERTERS FOR FORKLIFTS

#### What is a catalytic converter ?

- Catalytic converters reduce emissions of dangerous carbon monoxide (CO), hydrocarbons (HC), nitrogen oxides (NOx) and odour from diesel, gas, natural gas and propane-powered equipment

#### Untreated emissions

- Carbon monoxide (CO) is an odourless and colourless gas that causes headaches; in high concentrations, it can even cause death.
- Hydrocarbons (HC) cause eye & throat irritation and are responsible for odours and irritating fumes.
- Emissions from internal combustion powered equipment cause serious health hazards to employees working in enclosed environments.

#### CO Emissions Comparison

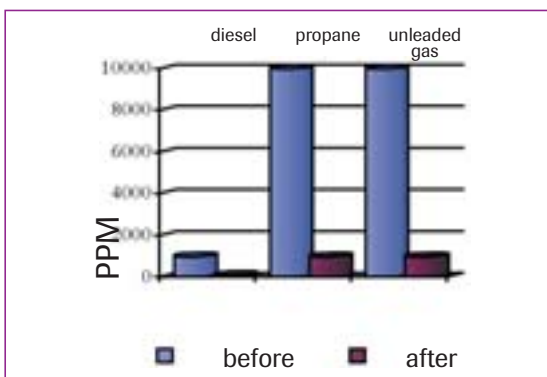

#### What can catalytic converters do ?

- Catalytic converters reduce emissions of carbon monoxide (CO) up to 99%, hydrocarbons (HC) up to 90% and diesel particles by up to 30%.

#### How does a catalytic converter work ?

- A catalytic converter contains a honeycomb in a steel housing or muffler.
- The honeycomb is coated with a catalyst formula, which induces chemical reactions as exhaust gasses enter and pass through the honeycomb.
- The effect of the catalyst formula is the conversion of the toxic gasses into harmless carbon dioxide (CO<sub>2</sub>) and water (H<sub>2</sub>O).

#### Oxidation catalytic converters ?

- Oxidation catalytic converters, or two-way catalytic converters, convert poisonous carbon monoxide (CO) and hydrocarbons (HC) into carbon dioxide and water.

#### Three-way catalytic converters ?

- Unlike oxidation catalytic converters, three-way catalytic converters offer the added reduction of nitrogen oxides (NOx).
- Three-way catalytic converters offer added NOx reduction by using a digital air/fuel ratio controller to maintain an optimum air/fuel ratio.
- The use of the air/fuel ratio controller combined with advanced three-way catalyst coating results in the elimination of toxic exhaust and the reduction of fuel consumption.



#### Catalytic converter advantage

- Each catalytic converter contains a patented stainless steel honeycomb, which is brazed to its stainless steel shell.
- The unique brazed design eliminates the possibility of the honeycomb loosening, cracking or telescoping inside the catalyst.

**For further information, please contact us.**

### INLINE CATALYTIC CONVERTERS



- Inline catalytic converters are custom-designed units made to suit each equipment make and model.
- Inline catalytic converters replace the exhaust tubing between the exhaust manifold and muffler, eliminating costly exhaust system modification and downtime.

### STANDARD DESIGN DIESEL CATALYTIC CONVERTERS



- Oxidation catalytic converters install directly in the exhaust gas stream between the exhaust manifold and muffler.
- Standard design catalysts are available either with two quick-release clamps, for removal of the catalyst center body, or as all-welded units with a fixed catalyst center body.

### CATALYTIC MUFFLER CONVERTERS



- Catalytic muffler converters are direct replacement mufflers, making installation quick and easy.
- Catalytic muffler converters offer exhaust purification without compromising noise reduction or creating excessive backpressure.
- Available in two or three-way catalyst reduction.

### STANDARD DESIGN LPG CATALYTIC CONVERTERS



- Standard catalysts for LPG engines clamp directly onto the existing tailpipe.
- Every catalyst is an exact fit, making installation quick and easy.

## CATALYTIC CONVERTERS FOR FORKLIFTS

Treatment of exhaust fumes: each engine produces emissions at different pollution levels.  
Exhaust fumes in PPM (particles per million)

Typical exhaust gas levels	harmfulness	LPG	Diesel	Gas
CO: Carbon oxides	toxic	380 - 10000	180 - 4000	18000 - 70000
NOx: Nitrogen oxides	toxic	180 - 4500	260 - 2000	250 - 4500
HC: Hydrocarbons	toxic	90 - 300	275 - 2000	250 - 600
Aldehydes	irritants	10 - 100	10 - 300	100 - 300
Soot / particle matter	toxic	-	0,24 g/m <sup>3</sup>	0,05 g/m <sup>3</sup>

Solution:

### 1) Oxidation catalytic converters.

The 2-way catalytic converter reduces CO gasses up to 99 % and HC gasses up to 90 %.

### A) STANDARD CATALYSTS FOR DIESEL ENGINE

standard welded design

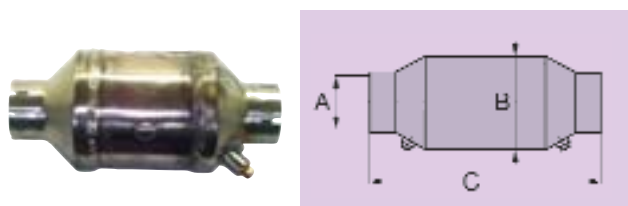

standard design with clamps

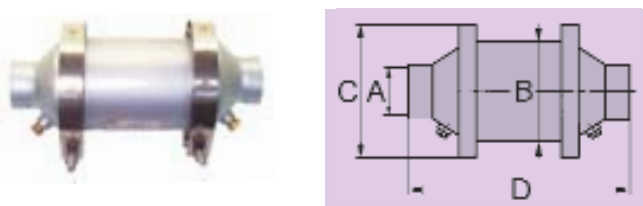

REF	Displacement	Dimensions (mm)		
		A	B	C
	(*)			
<b>107TA1908</b>	2380 cc	38	79	184
<b>107TA1909</b>	2380 cc	44 •	79	184
<b>107TA1910</b>	2380 cc	51 •	79	184
<b>107TA1911</b>	2380 cc	64	79	184
<b>107TA1912</b>	3970 cc	38	102	234
<b>107TA1913</b>	3970 cc	44	102	234
<b>107TA1914</b>	3970 cc	51 •	102	234
<b>107TA1915</b>	3970 cc	64 •	102	234
<b>107TA1916</b>	3970 cc	76 •	102	234
<b>107TA1917</b>	6290 cc	51	127	244
<b>107TA1918</b>	6290 cc	64	127	244
<b>107TA1919</b>	6290 cc	76 •	127	244
<b>107TA1920</b>	6290 cc	89	127	244
<b>107TA1921</b>	6290 cc	102	127	244
<b>107TA1922</b>	9230 cc	64	152	264
<b>107TA1923</b>	9230 cc	76	152	264
<b>107TA1924</b>	9230 cc	89	152	264
<b>107TA1925</b>	9230 cc	102	152	264

REF	Displacement	Dimensions (mm)			
		A	B	C	D
	(*)				
<b>107TA1926</b>	2380 cc	38	79	107	203
<b>107TA1927</b>	2380 cc	44 •	79	107	203
<b>107TA1928</b>	2380 cc	51 •	79	107	203
<b>107TA1929</b>	2380 cc	64	79	107	203
<b>107TA1930</b>	3970 cc	38	102	133	244
<b>107TA1931</b>	3970 cc	44	102	133	244
<b>107TA1932</b>	3970 cc	51 •	102	133	244
<b>107TA1933</b>	3970 cc	64 •	102	133	244
<b>107TA1934</b>	3970 cc	76 •	102	133	244
<b>107TA1935</b>	6290 cc	51	127	159	254
<b>107TA1936</b>	6290 cc	64	127	159	254
<b>107TA1937</b>	6290 cc	76 •	127	159	254
<b>107TA1938</b>	6290 cc	89	127	159	254
<b>107TA1939</b>	6290 cc	102	127	159	254
<b>107TA1940</b>	9230 cc	64	152	184	276
<b>107TA1941</b>	9230 cc	76	152	184	276
<b>107TA1942</b>	9230 cc	89	152	184	276
<b>107TA1943</b>	9230 cc	102	152	184	276

(•) = in stock. (\*) for turbo engines, please contact us.

**For further information, please contact us.**



## B) CATALYSTS FOR LPG & GAS ENGINES (LEAD FREE)

		<b>REF 107TA7671</b>	<b>REF 107TA7672</b>	<b>REF 107TA7673</b>	<b>REF 107TA7674</b>
	Max. engine power (kW)	32 (23,9)	32 (23,9)	53 (39,5)	53 (39,5)
	Max debit exhaust (m3/h)	192 (326)	192 (326)	318 (540)	318 (540)
	A inch (mm)	3.12 (79)	3.12 (79)	4.00 (102)	4.00 (102)
	B inch (mm)	1.75 (44)	2.04 (52)	2.04 (52)	1.75 (44)
	C inch (mm)	1.75 (44)	2.04 (52)	2.04 (52)	1.75 (44)
	D inch (mm)	11.77 (300)	11.77 (300)	13.75 (350)	13.75 (350)

## C) CUSTOM REPLACEMENT CATALYST

Inline and catalytic muffler converters, replace STD-muffler !  
Please indicate your make of truck + make of engine.  
Different models in stock.

*This is only a small selection, call for further details*

Example:	machine model	engine model	REF
CLARK	DPM 12-15-17-20S DPM 12-15-17-20S	MITSUBISHI S4E MITSUBISHI S4E2	107TA1944
CLARK	DPM 20-25-30	MITSUBISHI S4E	107TA1945
DAEWOO	G20-2S.30	HERCULES 2.7 L LPG 2 way	105TA6874
DAEWOO	D20-2S.30	DAEWOO DB33 DIESEL	107TA1946
DAEWOO	G20-2S.30	HERCULES 2.7 L LPG 2 way	107TA1947
DAEWOO	D50-60-70	PERKINS 4.236 DIESEL	107TA1948
DAEWOO	D20-2S.30-S3	DAEWOO DB33 DIESEL	107TA1949
DAEWOO	GC20-2S.30 S3	HERCULES 2.7 L LPG 2 way	107TA1950
DAEWOO	GP 20-2S-30 S3	HERCULES 2.7 LPG 2 way	107TA1951
DAEWOO	G25E	MITSUBISHI 4G64 LPG 2 way	107TA1952
HYSTER	H12.00 XL	PERKINS 1006.6 DIESEL	105TA6870
TOYOTA	5FD20-25-30	TOYOTA 1Z	107TA1953
MITSUBISHI	FD20-25 F18A	MITSUBISHI S4E	107TA1954



## 2) 3-way converters

The 3-way catalytic converters reduce harmful gases, including nitrogen oxides (NOx) by up to 95%.  
A 3-way system allows trucks with LPG engines to work safely in enclosed areas due to extremely low emission levels.

Please indicate your make of truck + make of engine.  
Different models in stock.

### More than 1.000 different models available:

ALLIS CHALMERS - CATERPILLAR - CLARK - DAEWOO - FIAT  
HYSTER - KOMATSU - LINDE - MANITOU - MITSUBISHI  
NISSAN - TOYOTA - TCM - YALE

**For further information, please contact us.**



## EXHAUST FUME WASHER

- The exhaust fumes are led through a water bath.
- The water retains the soot.
  - Advantage: cost price.
  - Disadvantage: lower efficiency, daily maintenance.

**WATER-MUFFLER FOR DIESEL EXHAUST GAS.**

This type of water muffler gives an answer to the problem of the "black smoke", which is caused by diesel engines. By reducing the grade of black smoke, and soot by 85% and consequently a large part of all bad smelling and irritating substances with the help of an exhaust gas "cleaning" mechanism.

Fumes pass through the cleaning fluid (water) in order to deposit all unburnt hydrocarbons, at the bottom of the tank, as a part of sulphurous compounds and aldehydes (which are the reason for the typical smell and grade of smoke of diesel engines). With the help of this cleaning system a considerable temperature drop of exhaust fumes is also reached, in this way the transformation of nitric oxides into very noxious nitric dioxides is avoided. They are kept constantly under the flash point of eventual fumes present in the working environment.

- It is an excellent silencer and spark quencher in conformity with explosion-proof standards CEI 31-11 and European standards CENELEC EN 50014 and 50018.
- Its temperature is lower than class "T5" (100° C).
- Works as spark arrestor also without water.

**MOUNTING:**

It can be mounted on any part of the forklift, even if it is far away from the engine.

1. Remove the pre-existing muffler (in order to avoid an increase in back pressure).
2. Fix the muffler on the forklift chassis by means of the fitting brackets which you can find on the lower part.
3. Connect the tube coming from the manifold to the inlet flange of the muffler by inserting a flexible tube section between them

**MAINTENANCE:**

The maintenance is very simple, fast and economic. Actually, it simply requires the water replacement every 8 working hours. Emptying the tank first, opening the fitting tap and afterwards refilling the tank with water. Clean the muffler every 300 working hours. Empty the water tank and wash the inside with a pressure water jet for 2 or 3 minutes.

**WARNING:**

Do not use sea water (salt) or water-containing chloride !!!

**REF 124TA2654**

This product is used to keep the inside of the purifier clean; extending maintenance intervals. TAM additive also serves to improve purification by neutralising sulphuric and sulphurous acids and nitrogen oxides. We recommend using a fresh dosage of TAM additive every time the body of water is replaced. The TAM additive is provided in convenient containers with screw caps holding a volume of 150cc.

**IMPORTANT NOTE FOR GUARANTEE**

The Gorgo purifiers are entirely manufactured in AISI 316 stainless steel. This material is resistant to high temperature and to corrosive sulphurous compounds which are present in the exhaust gas.

In spite of all that, in some applications, permanent corrosion damage can be caused, and is not covered by the guarantee.

The causes of the corrosion can be the followings:

- use of fuel with high sulphur content
- use of water with a chlorine content of > 50 ppm
- use of seawater or brackish water
- irregular purifier maintenance, you must change every 8 hours the water and add the TAM Additive (keep your accounts from the additive to beware your guarantee)



EXHAUST FUME WASHER

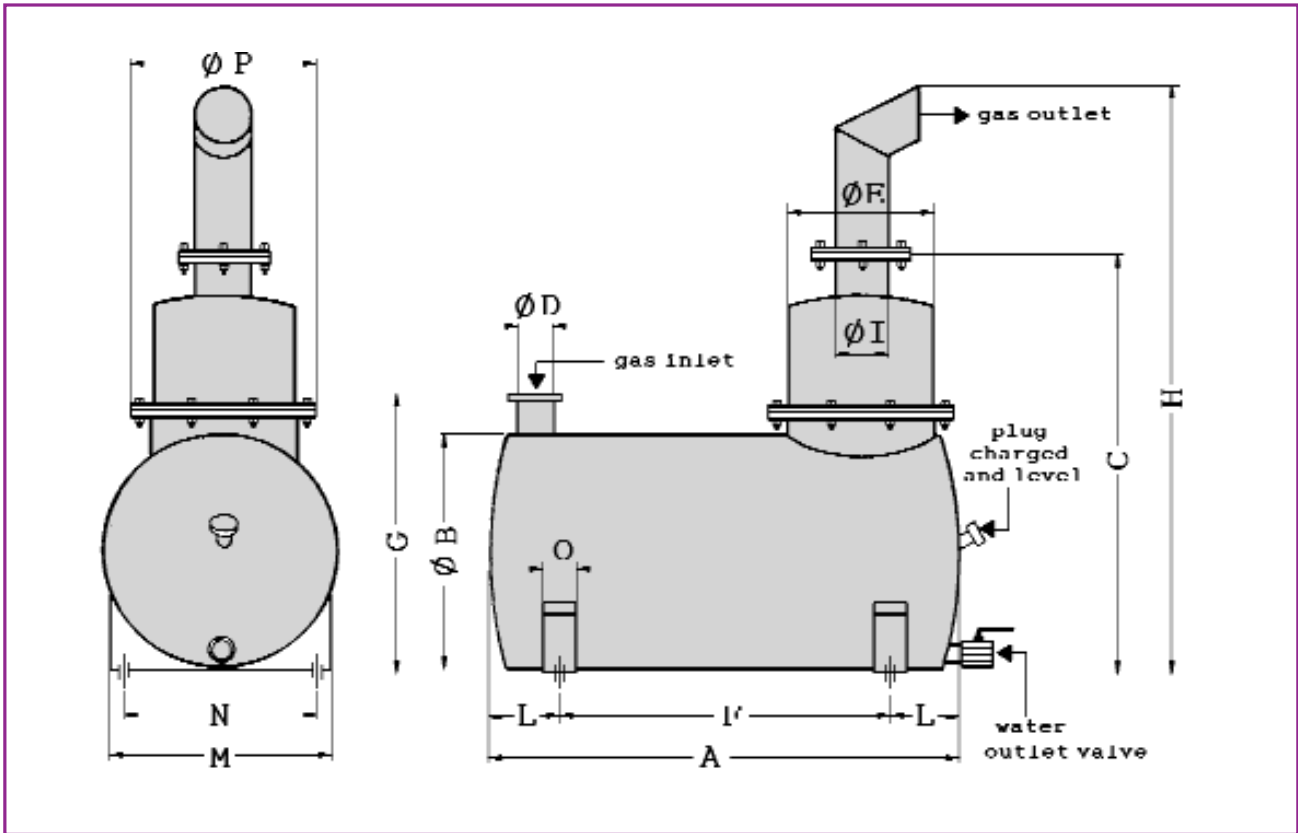

REF	Engine power	A	Ø B	C	Ø D	Ø E	F	G	H	Ø I	L	M	N	O	Ø P
107TA1956	up to KW 15 (pk 20)	450	300	600	40	150	290	350	800	50	80	268	205	45	-
107TA1957	up to KW 37 (pk 50)	570	350	700	50	180	350	400	1380	80	110	303	230	60	230
107TA1958	up to KW 59 (pk 80)	660	350	700	50	200	430	400	1380	80	115	303	230	60	250
107TA1959	up to KW 81 (pk110)	750	370	740	60	230	530	420	1420	80	110	342	280	70	280
107TA1960	up to KW110 (pk150)	950	400	740	80	300	620	450	√	100	165	362	290	70	350
107TA1961	up to KW 184 (pk 250)	1000	600	1000	100	400	750	650	√	100	125	556	480	100	450
107TA1962	up to KW 258 (pk 350)	1100	700	1100	120	420	800	750	√	120	150	610	520	100	470

## SOOT FILTER WITH REPLACEABLE CARTRIDGES

### Soot filter replaceable elements:

- The soot is retained by a special replaceable filter element.
  - Advantage: 99,98 % efficiency.
  - Disadvantage: replacement of elements (every 300 to 400 hours).
- Please advise truck type + engine power + installation counterweight or installation on roof.



### Function:

The "heart" of the soot filter is an interchangeable filter element that is composed of cellulose. This element has the ability to withstand high temperatures (in comparison with an ordinary filter) and reduces the emission of diesel soot by 99%.

### Composition:

The system consists of a filter housing, with filter element, counter pressure valve + indicator, temperature safety valve + outlet valve and flexibles.

The filter is available for both assembly on the counterweight and assembly on the roof.

### Maintenance:

The element should be replaced every 300 to 400 hours, with normal use.

**Please supply truck model, serial number and engine type**

REF complete	Engine power	Element	REF element
107TA1966	80 PK	Ø11" 340°C	107TA1963 (2x)
107TA1967	60 PK	Ø15" 320°C	102TA6003
107TA1968	50 PK	Ø11" 320°C	107TA1965





## SOOT FILTER FOR DIESEL ENGINES

### Soot filter for:

- Forklift diesel engines, construction machinery
- Stationary diesel engines

### Function:

The soot filter is composed of ceramic materials, packed gas-free in a stainless steel plate. The ceramic monoliths contain a certain number of square cells with parallel channels, which are sealed by turns; the separation between these channels is porous. The diesel exhaust flows through these separations and is filtered by the surface and pores in the ceramic material. This filtration removes up to 98% of soot from the exhaust fumes. The filtered particles are then burnt by regenerating the filter in a separate oven.

### Type EWR:

- Removes up to 98% of soot
- Life span 8 to 10 hours
- Usable in every situation
- Adapts to any kind of truck through its element structure
- Quick and easy change of the filter
- Continuous operation when using multiple filters
- Electronically operated filter regeneration within 50 to 90 minutes
- Can be placed horizontally or vertically
- Requires little space, no obstruction of sight
- Only one regeneration oven needed for multiple filters.



SOOT FILTERS

REF	SOOT FILTER
107TA1969	0-20 KW
107TA1970	20-60 KW
107TA1971	60-120 KW
107TA1972	120-160 KW
107TA1973	160-200 KW





TEMPORARY EXHAUST FILTERS

TEMPORARY EXHAUST FILTERS

**EXHAUST CLEANER FOR STARTING INSIDE BUILDINGS**



complete filter:  
**REF 105TA2744**



replacement element:  
**REF 105TA2745**



connecting cone:  
d min. = 35 mm  
d max. = 70 mm  
**REF 105TA2746**



connecting cone:  
d min. = 25 mm  
d max. = 45 mm  
**REF 105TA2747**



This filter is an exhaust cleaner for **temporary use** of vehicles in factories, ships, workshops, exhibition halls etc...

The filter functions immediately when starting the truck, gives maximum flexibility indoors and is not affected by moisture.

The filter removes all hazardous substances from the exhaust particles.

**TECHNICAL DATA**

For use inside buildings

particle separ.	>99,9 %
Co separ.	+/- 30 %
Nox separ.	+/- 60 %
Rc Ho separ.	+/- 90 %
Hc separ.	+/- 35 %
Max. engine	5,5 L cyl col
Max. rpm	2500 rpm
Max const. temp	200°C
Max temp. 30 sec.	350°C

Expected lifetime:

> 300 starts; for petrol (3,0 L engine)

> 75 starts; for diesel (3,0 L engine)

Weight 0,4 Kg

PARTICULE DETAINING EXHAUST

It reduces, as far as possible, the unburnt residues (particules) in the exhaust fumes of diesel endothermic engines. The cylindrical casing with external protection in perforated sheet metal contains a dry filtering cartridge (fire-retardant) which detains the solid particles of the exhaust fumes. In forklift trucks it is rapidly installed instead of the vertical silencer.



Securing solutions



Filter replacement

REF	Ø	Length	Discharge	Engine Power
115TA6910	115	800	Vertical	0-52 kw
115TA6912	Filter element for 115TA6910			

- **Rapid installation**
- **It acts as a silencer**
- **it does not create vapours or liquid residues**
- **it is rapidly replaced**
- **it is compact**
- **the cartridges last 200 hours approximately**
- **global damping of the particules of around 70%**

SPARK ARRESTORS FOR FORKLIFTS

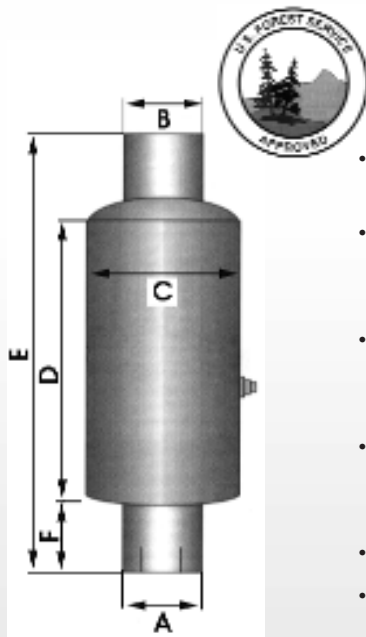

**No more flames thanks to the centrifugal system.**

- Designed for universal application with a minimum of restriction on the engine.
- They work well as add-on units to existing exhaust systems. Their lightweight and small size reduces stress and vibration to the rest of the exhaust system.
- Typical applications include logging and construction equipment, agricultural machinery, over-the-road trucks, airport equipment, forestry and military vehicles.
- All arrestors exceed U.S. forestry requirements and are qualified and tested for vertical and horizontal installations under the U.S. forestry Service Standard 5100-1b.
- All inlets are slotted tube connections. Outlets are O.D. tubing.
- CFM rating is based on a pressure drop of 1 PSI.

inner ø A	outer ø B	C	D	E	F	CFM	l/min	REF
27mm - 1,05"	32mm - 1,25"	108mm	81mm	150mm	33mm	80	2266	<b>122TA7586</b>
38mm - 1,50"	38mm - 1,50"	108mm	79mm	150mm	36mm	165	4675	<b>107TA1976</b>
51mm - 2,00"	51mm - 2,00"	143mm	163mm	279mm	51mm	295	8357	<b>108TA8876</b>
64mm - 2,50"	67mm - 2,63"	143mm	218mm	325mm	51mm	450	12748	<b>107TA1978</b>
76mm - 3,00"	80mm - 3,13"	168mm	259mm	378mm	64mm	660	18696	<b>104TA5741</b>
89mm - 3,50"	92mm - 3,63"	194mm	305mm	447mm	76mm	900	25496	<b>107TA1979</b>
102mm - 4,00"	105mm - 4,13"	216mm	371mm	538mm	86mm	1180	33427	<b>122TA7587</b>
127mm - 5,00"	130mm - 5,13"	244mm	406mm	310mm	102mm	1840	52123	<b>122TA7588</b>
152mm - 6,00"	156mm - 6,13"	308mm	559mm	686mm	51mm	2650	75069	<b>122TA7589</b>

SPARK ARRESTORS

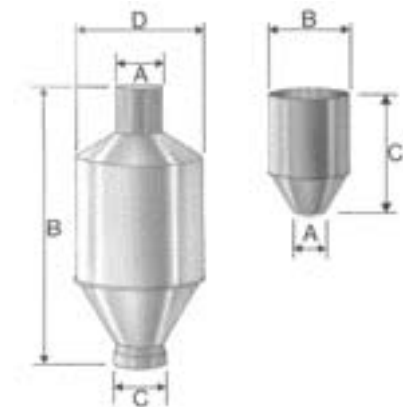

REF	Engine power		Dimensions (mm)			
	PK	KW	A	B	C	D
<b>107TA1974</b>	25-65	18-48	70	335	70	188
<b>107TA1975</b>	50-125	37-92	70	401	70	188

**For further information, please contact us.**





TECHNICAL DETAIL: EXHAUST TUBES

EXAMPLE

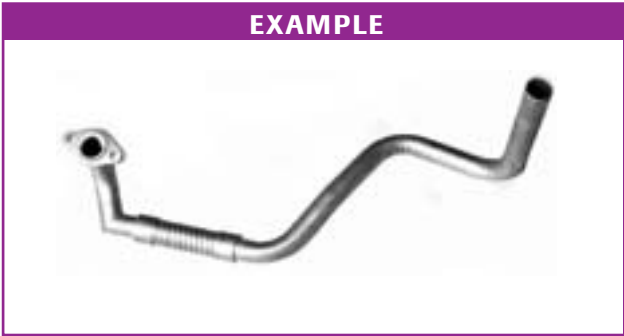

Company: .....

Customer code: .....

Name: .....

Fax number: .....

Truck make: .....

Truck type: ..... Serial nr.: .....

MEASUREMENTS:

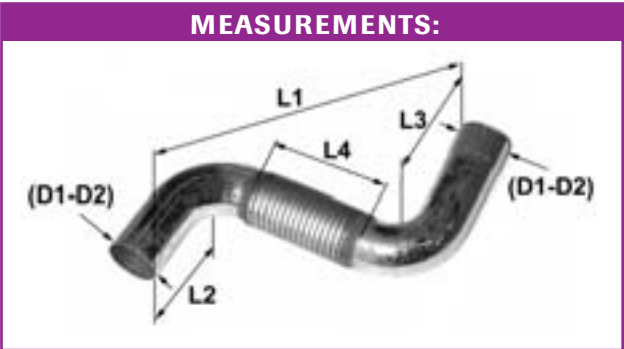

FLANGE TYPE:

A) Oval

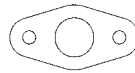

B) Triangular

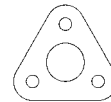

C) Square or rectangular

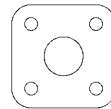

D) Special flange  
(none of the previous)

E) No flange

- 1 L1: ..... Minimum distance between two ends (if flexible, please stretch out to ..... the full length). Remark: if 3 tubes, take the minimum distance between the ..... tubes with the largest diameters.
- 2 AT-BO: ..... Number of bends: if flexible, this does not count as a bend, unless it is ..... explicitly seen as a bend.
- 3 TY-FL ..... Type of flange (see diagrams). If 2 different flanges are present, ..... please note order as mentioned in the list: e.g. AC and not CA.
- 4 D1: ..... Outer diameter of smallest tube.
- 5 D2: ..... Outer diameter of largest tube.
- 6 L2: ..... Smallest distance to centre of first bend (see drawing).
- 7 L3: ..... Largest distance to centre of first bend (see drawing).
- 8 L4: ..... Length of flexible, completely stretched out (if present)
- 9 GA: ..... Heat-resistant protection present yes/no
- 10 SUP: ..... Sum of fixing points; hooks, levers, thread, etc...

IMPORTANT

- The diameters are measured on the outside of the tip of the tube.
- If 3 tubes, take the 2 largest diameters.

FAX FORM: EXHAUST TUBES

USED FOR: CATERPILLAR



REF	105TA7062
L1	390
AT-BO	1
TY-FL	A
D1	47
D2	47
L2	95
L3	360
L4	275
GA	NO

USED FOR: HYSTER



REF	105TA6922
L1	640
AT-BO	4
TY-FL	A
D1	32
D2	32
L2	80
L3	125
L4	0
GA	NO

USED FOR: HYSTER



REF	106TA6315
L1	252
AT-BO	0
TY-FL	E
D1	53
D2	53
L2	0
L3	0
L4	200
GA	NO

USED FOR: KOMATSU



REF	105TA7068
L1	575
AT-BO	4
TY-FL	A
D1	34
D2	43
L2	15
L3	105
L4	155
GA	NO

USED FOR: KOMATSU



REF	106TA6313
L1	328
AT-BO	1
TY-FL	A
D1	42,5
D2	42,5
L2	75
L3	255
L4	140
GA	NO

USED FOR: MITSUBISHI



REF	105TA7014
L1	370
AT-BO	3
TY-FL	E
D1	38
D2	39
L2	50
L3	100
L4	0
GA	NO

USED FOR: KOMATSU



REF	105TA6884
L1	630
AT-BO	6
TY-FL	A
D1	34
D2	34
L2	70
L3	275
L4	105
GA	NO

USED FOR: TOYOTA



REF	106TA6316
L1	295
AT-BO	3
TY-FL	A
D1	43
D2	43
L2	60
L3	85
L4	0
GA	YES

USED FOR: TOYOTA



REF	106TA6312
L1	510
AT-BO	4
TY-FL	A
D1	42,5
D2	42,5
L2	35
L3	220
L4	0
GA	YES

USED FOR KOMATSU



REF	106TA6250
L1	565
AT-BO	3
TY-FL	C
D1	37
D2	40
L2	37
L3	75
L4	0
GA	YES

USED FOR CLARK



REF	106TA6314
L1	325
AT-BO	2
TY-FL	B
D1	48
D2	48
L2	55
L3	65
L4	0
GA	NO

USED FOR MITSUBISHI



REF	106TA7390
L1	390
AT-BO	1
TY-FL	A
D1	38
D2	43
L2	170
L3	230
L4	0
GA	NO

USED FOR KOMATSU



REF	106TA7391
L1	440
AT-BO	3
TY-FL	E
D1	42
D2	47
L2	45
L3	95
L4	175
GA	NO

USED FOR CLARK



REF	105TA7149
L1	450
AT-BO	3
TY-FL	B
D1	48
D2	49
L2	45
L3	95
L4	0
GA	NO

USED FOR TOYOTA



REF	106TA7392
L1	745
AT-BO	5
TY-FL	A
D1	43
D2	43
L2	90
L3	130
L4	140
GA	NO

USED FOR KOMATSU



REF	105TA7285
L1	475
AT-BO	2
TY-FL	E
D1	43
D2	47
L2	100
L3	155
L4	175
GA	NO

USED FOR CATERPILLAR



REF	105TA7035
L1	795
AT-BO	2
TY-FL	E
D1	50
D2	55
L2	130
L3	195
L4	0
GA	NO

USED FOR KOMATSU



REF	105TA7068
L1	575
AT-BO	4
TY-FL	A
D1	34
D2	43
L2	15
L3	105
L4	155
GA	NO

USED FOR MITSUBISHI



REF	105TA6921
L1	370
AT-BO	1
TY-FL	A
D1	38
D2	42
L2	80
L3	315
L4	180
GA	NO

EXHAUST TUBES



## TECHNICAL DETAIL: SILENCERS

### EXAMPLE



### MEASUREMENTS:



Company: .....

Customer code: .....

Name: .....

Fax number: .....

Truck make: .....

Truck type: ..... Serial nr.: .....

### MAIN TYPES:

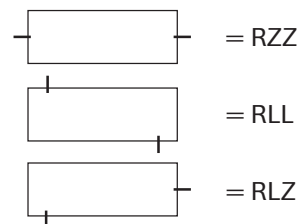

### MAIN TYPES:

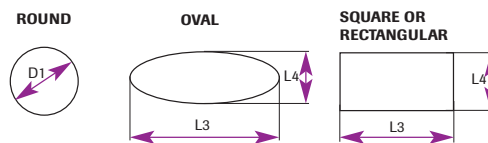

- 1 **TY:** ..... 3 main types - see diagrams  
**R=** round  
**O=** oval  
**V=** square or rectangular

Ex. OLZ: oval exhaust with a tube in the body and the side

Remark: To determine the position of the tube, always start with the body and then check the side

- 2 **L1:** ..... Length of the silencer body, see diagram (mm)  
 3 **L2:** ..... Minimum distance between the 2 tubes (mm)

Remark: if 3 tubes, take the minimum distance between the tubes with the largest diameters.

- 4 **D1:** ..... Diameter, see diagrams (mm)  
 5 **L3:** ..... Length, see diagrams (mm)  
 6 **L4:** ..... Length, see diagrams (mm)  
 7 **D2:** ..... Smallest diameter tube  
 8 **D3:** ..... Largest diameter tube  
 9 **AT-BG:** ..... Number of mounting points

### IMPORTANT

- The diameters are measured on the outside of the tip of the tube.
- If 3 tubes, take the 2 largest diameters.



## USED FOR: NISSAN



REF	104TA5795
TY	OZZ
L1	400
L2	590
D1	0
L3	210
L4	110
D2	38
D3	47
AT-BG	2

## USED FOR: LINDE



REF	104TA5886
TY	RZZ
L1	750
L2	970
D1	90
L3	0
L4	0
D2	56
D3	70
AT-BG	1

## USED FOR: LINDE



REF	105TA6851
TY	RZZ
L1	800
L2	1200
D1	100
L3	0
L4	0
D2	43
D3	57,2
AT-BG	1

## USED FOR: TOYOTA



REF	105TA6715
TY	RZZ
L1	330
L2	200
D1	190
L3	0
L4	0
D2	38
D3	42
AT-BG	2

## USED FOR: MITSUBISHI



REF	105TA6766
TY	RZZ
L1	285
L2	515
D1	190
L3	0
L4	0
D2	43
D3	43
AT-BG	2

## USED FOR: TOYOTA



REF	105TA6760
TY	RLZ
L1	350
L2	290
D1	170
L3	0
L4	0
D2	38
D3	46
AT-BG	2

## USED FOR: TOYOTA



REF	106TA4994
TY	RZZ
L1	340
L2	250
D1	190
L3	0
L4	0
D2	38
D3	42
AT-BG	3

## USED FOR: YALE



REF	106TA6309
TY	RZZ
L1	1073
L2	1110
D1	90
L3	0
L4	0
D2	43
D3	49
AT-BG	1

## USED FOR: TOYOTA



REF	105TA6785
TY	RLZ
L1	328
L2	335
D1	164
L3	0
L4	0
D2	38
D3	47
AT-BG	2

## USED FOR HYSTER



REF	104TA5868
TY	RLL
L1	380
L2	270
D1	150
L3	0
L4	0
D2	36
D3	36
AT-BG	2

## USED FOR CLARK



REF	104TA5965
TY	RLL
L1	305
L2	200
D1	150
L3	0
L4	0
D2	41
D3	48
AT-BG	1

## USED FOR SAXBY



REF	104TA5735
TY	RLL
L1	440
L2	310
D1	90
L3	0
L4	0
D2	35
D3	42
AT-BG	1

## USED FOR YALE



REF	106TA5005
TY	RZZ
L1	288
L2	390
D1	157
L3	0
L4	0
D2	35
D3	38
AT-BG	2

## USED FOR LINDE



REF	106TA7389
TY	RZZ
L1	1565
L2	495
D1	0
L3	0
L4	0
D2	60
D3	66,2
AT-BG	1

## USED FOR CLARK



REF	104TA5849
TY	OLZ
L1	450
L2	440
D1	0
L3	190
L4	130
D2	48
D3	53
AT-BG	2

## USED FOR FIAT



REF	104TA5880
TY	RZZ
L1	505
L2	610
D1	130
L3	0
L4	0
D2	46
D3	49
AT-BG	2

## USED FOR TCM



REF	104TA5887
TY	OZZ
L1	400
L2	230
D1	0
L3	200
L4	115
D2	39
D3	48
AT-BG	2

## USED FOR CLARK



REF	104TA5790
TY	OLL
L1	250
L2	150
D1	0
L3	230
L4	160
D2	48
D3	53
AT-BG	1

## USED FOR YALE



REF	106TA7788
TY	RZZ
L1	740
L2	1042
D1	100
L3	0
L4	0
D2	38
D3	54
AT-BG	1



## ANALYZERS 4-5 GAZ

GAS ANALYSER



### REF 122TA7541

Analyzer 4 gas (CO, HC, CO<sub>2</sub>, O<sub>2</sub>), OIML Class 1 certified

- Shockproof, identification IMPCO
- Trapdoor for water and filter (5 filters included)
- Charger 12 VAC
- Escape borer
- Interface multi language GB, D, F, SP and NL
- Transport suitcase and instruction leaflet
- PC link cable and infrared printer available separately

### REF 122TA7542

Analyzer 4 gas (CO, HC, CO<sub>2</sub>, O<sub>2</sub>), not OIML Class 1 certified

- Shockproof, identification IMPCO
- Trapdoor for water and filter (5 filters included)
- Charger 12 VAC
- Escape borer
- Interface multi language GB, D, F, SP and NL
- Transport suitcase and instruction leaflet
- PC link cable and infrared printer available separately

### REF 122TA7543

Analyzer 5 gas (CO, HC, CO<sub>2</sub>, O<sub>2</sub>) identical to model 122TA7541 with Nox module and certificate OIML Class 1

- PC link cable and infrared printer available separately

### REF 122TA7544

Analyzer 5 gas (CO, HC, CO<sub>2</sub>, O<sub>2</sub>) identical to model 122TA7541 with Nox module and certificate OIML Class 1

- specific transport suitcase
- feeding cable
- portable infrared printer
- oil temperature and RPM borers
- PC link cable and infrared printer **included**

### REF 122TA7545

Analyzer 5 gas (CO, HC, CO<sub>2</sub>, O<sub>2</sub>) identical to model 122TA7541 with Nox module but without certificate OIML Class 1

- PC link cable and infrared printer available separately

### How do you check the emissions of your lift trucks?

The IMPCO portable gas analyser allows you to establish new criteria for use, user-friendliness and interpretation of measurements.

Weight: 1.1 kg, can be held in one hand and has an autonomy of several hours thanks to its built-in battery. The internal memory stores up to 150 measurements of exhaust fumes, performed by controlled applications.

The infrared detection system, a unique feature on devices in this range, can display up to 4 measurements at the same time, and has an optional illuminated display. (Nox optional)

A PC link cable and infrared controlled printer are available separately.

With an accuracy as good as any other quality device, the IMPCO gas analyser is perfectly adapted to the material handling, the pre-conformity test and test on engine diagnostics and tune-up.

The IMPCO analyser can even be used under changing atmospheric pressure and temperatures.

### Field of operation:

All thermic ignition-based applications

### Advantages:

- For all Gasoline, LPG, GNV applications
- Measures: CO, HC, CO<sub>2</sub>, O<sub>2</sub>, Lambda, Nox *optional*
- Temperature and RPM probe
- Easy to use and to read
- Up to 150 measurements stored in memory
- Automatic calibration
- Autonomy: up to 8 hours stand-by
- Input: 12, 110, 220 volts



	Maximum range	Normal range	Resolution
CO	20%	5%	0,01
HC	10000	2000ppm	1
O <sub>2</sub>	25%	21%	0,02
CO <sub>2</sub>	20%	16%	0,1
NOX	0 - 5000ppm	5000ppm	1

Device	Dimensions	240 x 135 x 160 mm
	Weight	1,1 kg
Range of operation	de +5°C until 40°C	
Environment	860 - 1060 hPa	
Power supply	12, 110, 230 Volts	
Autonomy	8 hours stand-by 4 hours operational	
Memory	Up to 150 registered measurements	

Supplied with a rubber protection sleeve, a water reservoir and filter, a transport case, a sectorial charger/adaptor, an exhaust pipe probe, a RPM probe and an oil temperature probe.



## SMOKE TEST SET



Determines efficient combustion and is internationally recognized as the standard method for evaluating smoke density in the flue gasses from distillate fuels. Too much smoke is one of the most common causes of excessive fuel usage and expensive service requirements.

That is precisely why the smoke test set is an indispensable part of any oil burner service job; and with the tester, an accurate smoke reading takes less than a minute. The 10 spots on the scale range in equal photometry steps from white to black to completely cover any smoke condition which may be experienced on residential or commercial oil burners.

**REF 106TA6388**

## CARBON MONOXIDE ANALYSER



The CO-analyser is a hand-held instrument designed to locate CO in ambient air as well as in stack gasses. The continuous sampling instrument quickly and accurately measures levels of CO between 0 and 2.000 ppm.

## FEATURES

- quickly measures and displays low levels of CO 0-2.000 ppm
- measures in increments of 1 ppm
- multi-purpose strap for easy holding
- probe and hose assembly for flue gas testing
- highly visible digital display with backlight

## TYPICAL APPLICATIONS

- CO safety checks on combustion stack gas and ambient air levels
- Analysing indoor air quality and safety
- furnace and boiler servicing or replacement
- BAM verifies CO exposure

**REF 106TA6390**

## PIPE CUTTER

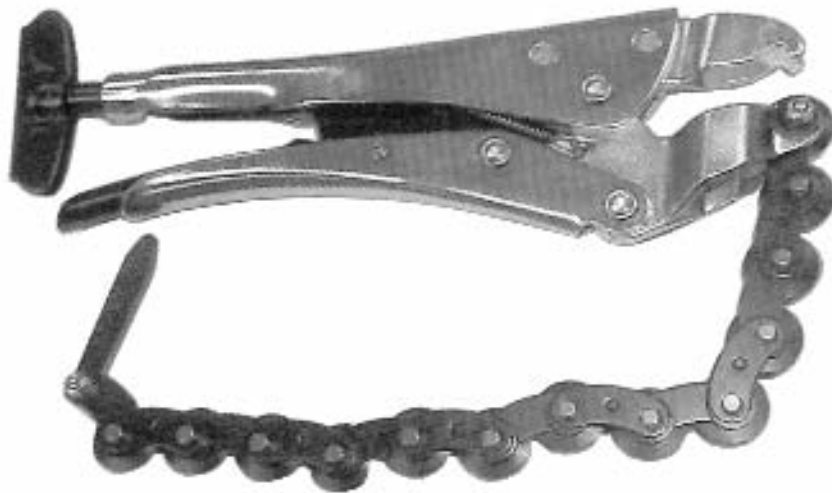

**REF 111TA1914**  
diameter: 19-76 mm

## PIPE EXPANDER



**REF 111TA1916**  
43 - 64 mm

## PRESSURE GAUGE



**REF 107TA1980**  
To check the back pressure between  
the engine and the catalyst.

## PIPE EXHAUST SLEEVE

	REF
Ø 40	107TA1981
Ø 45	107TA1982
Ø 50	107TA1983
Ø 57	107TA1984
Ø 76	107TA1985



SOLD PER METRE

## HEAT RESISTANT EXHAUST WRAPPING



### REF 111TA4010

- Heat resistant
- Length: 50 metre roll
- Width: 30 mm

## DIESEL COMBUSTION



### REF 107TA1989

Improved diesel combustion  
400 ml

## EXHAUST REPAIR PASTE



### REF 107TA1992

The quick repair for sound absorbers and outlet systems.

## EXHAUST MOUNTING PASTE



### REF 107TA7713

High temperature paste / 200 gr

## HEAT RESISTANT PAINT



### REF 107TA1990

Black / 400 ml

### REF 107TA1991

Silver / 400 ml

## HEAT RESISTANT GLOVES



### REF 107TA1988

heat resistant glove  
resists against heat up to 600°C (32sec.)

## HEAT RESISTANT GLOVES



### REF 107TA1987

heat resistant glove  
resists against heat up to 350°C (15sec.)

## COPPER SPRAY



### REF 107TA1986

Copper spray (400 ml)